

1B Version 10/24/18

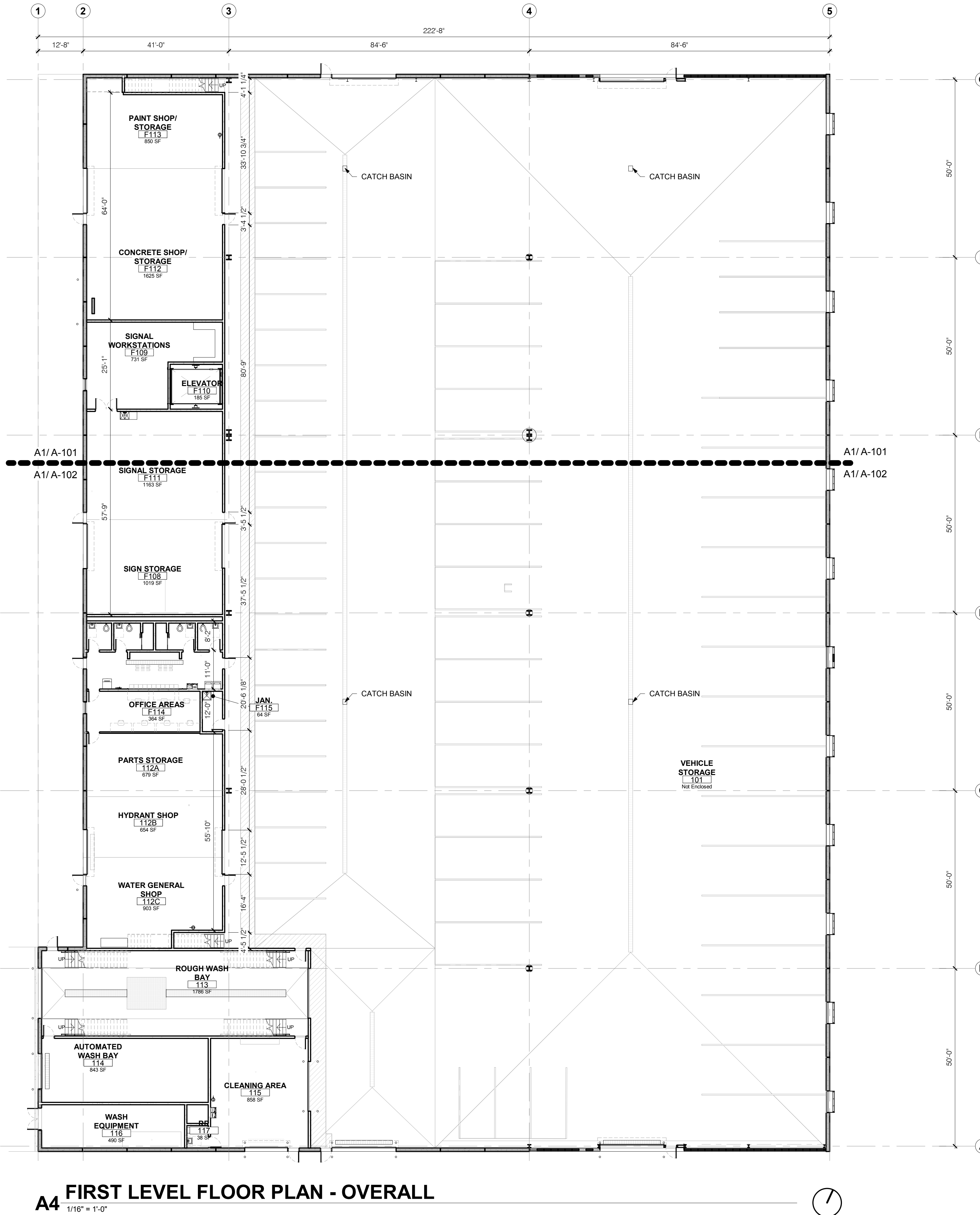
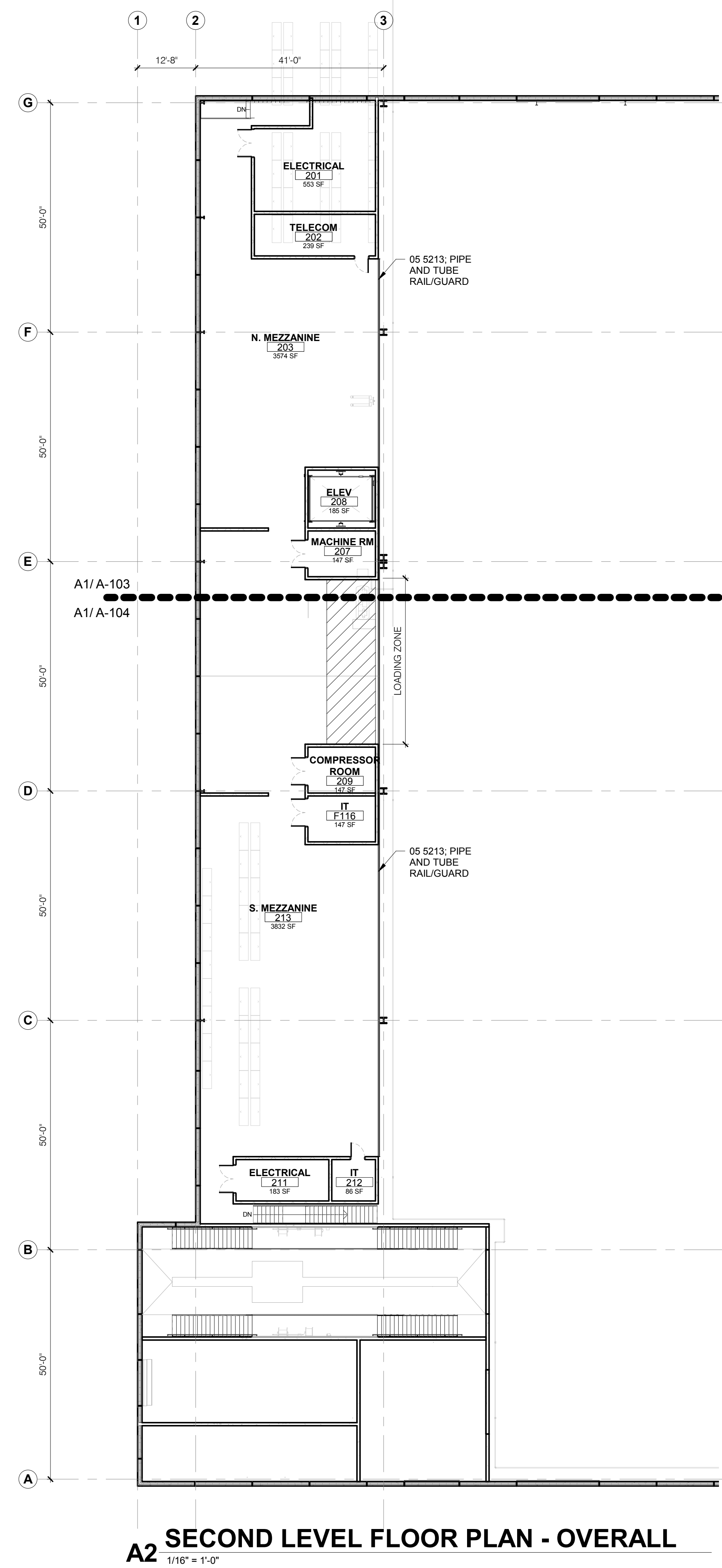
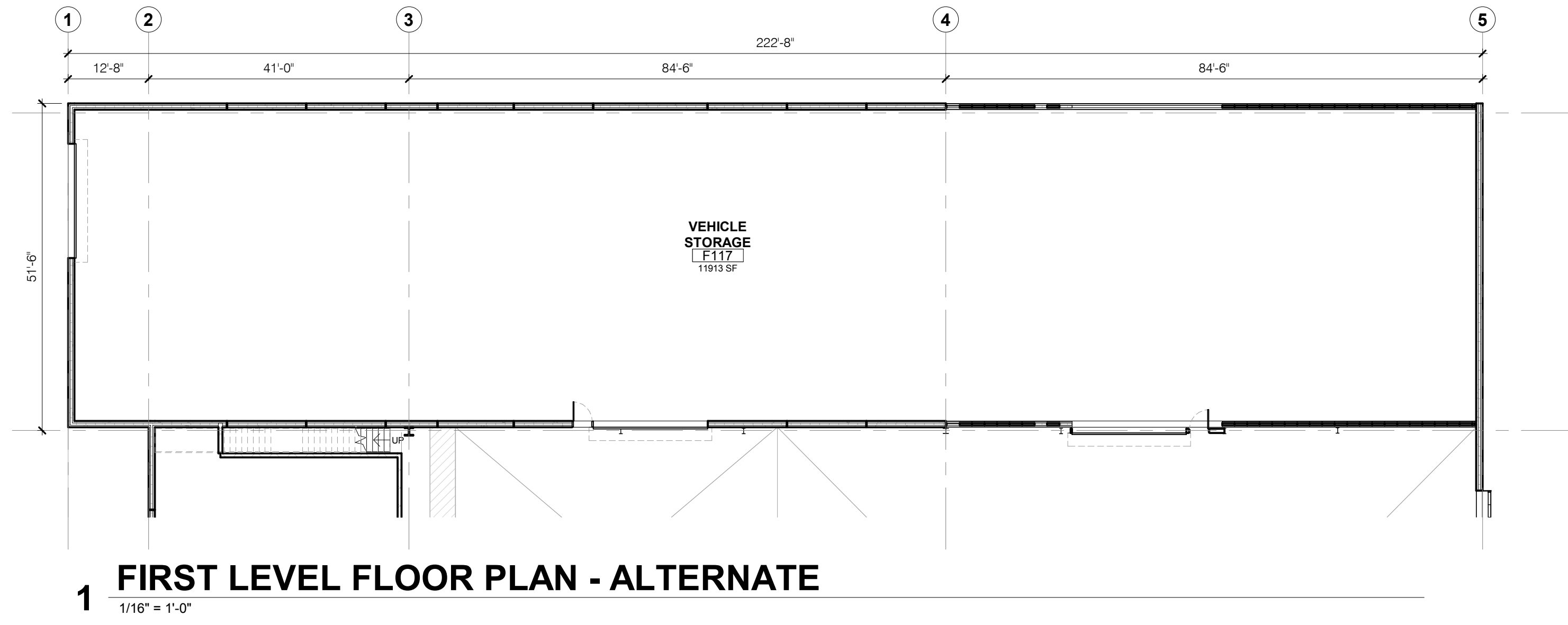
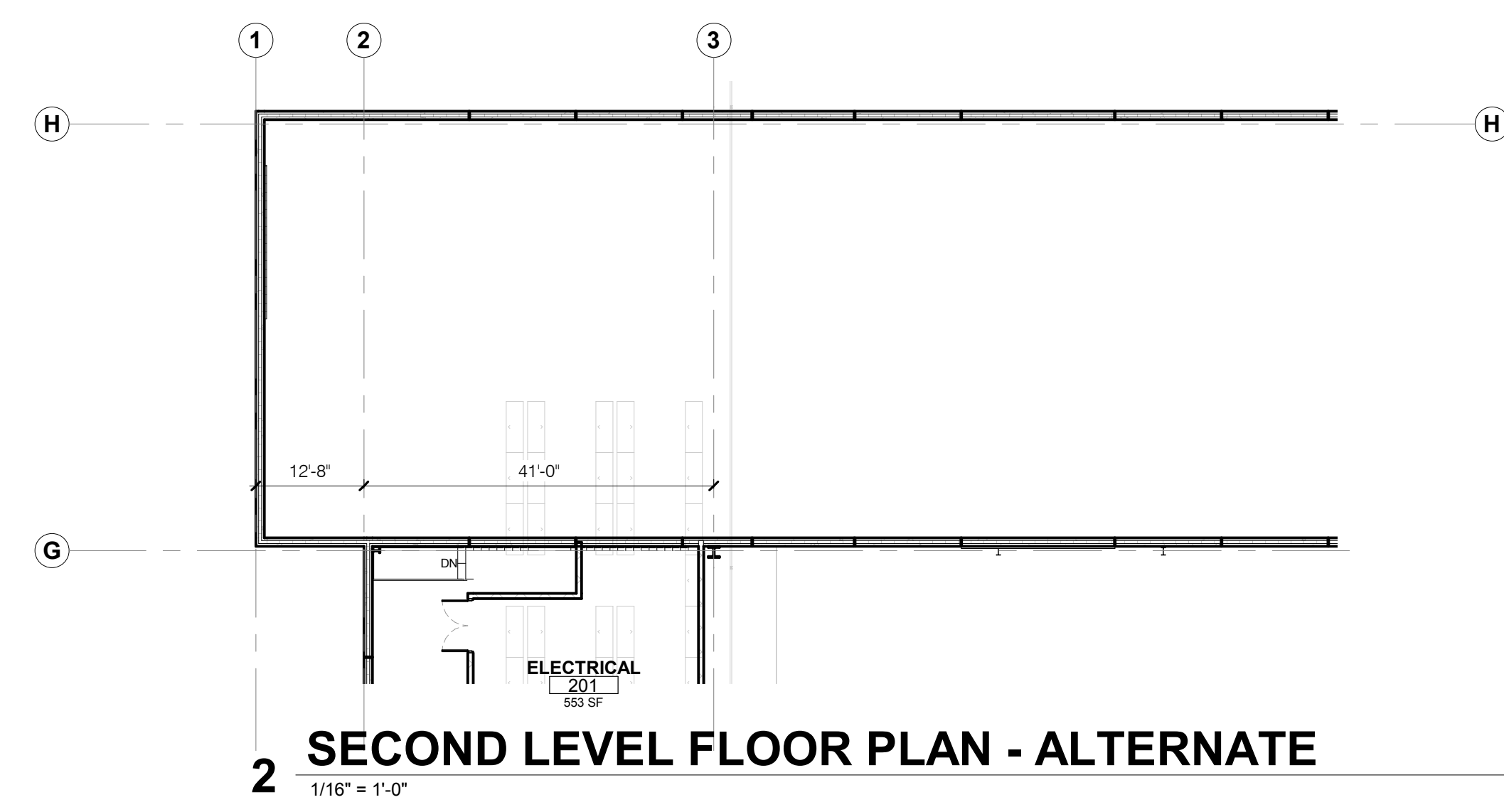

GENERAL FLOOR PLAN NOTES

1. ALL DIMENSIONS ARE TO FACE OF STUD OR MASONRY, UNLESS OTHERWISE NOTED.
2. WALLS TO BE TYPE L3.4, UNLESS OTHERWISE NOTED.
3. REPAIR AND PATCH CONCRETE FLOOR WHERE DAMAGED OR UNFINISHED RESULTING FROM DEMOLITION WORK.
4. WHEREVER DEMOLITION OF WALLS, CEILINGS, FLOORS, CASEWORK, OR OTHER ITEMS RESULTS IN EXPOSED, UNFINISHED EDGES, PLANES, OR FACES OF ADJOINING WALLS, CEILINGS, FLOORS, ETC., THESE UNFINISHED ELEMENTS SHALL BE REPAIRED, PATCHED AND FINISHED WITH LIKE/COMPATIBLE MATERIALS AS REQUIRED TO MATCH ADJACENT SURFACE, UNLESS OTHERWISE NOTED IN THE DOCUMENTS.
5. WHERE REMOVAL OF ITEMS REQUIRED BY THIS CONTRACT, INCLUDING PLUMBING, MECHANICAL, ELECTRICAL, AND TELECOM ITEMS, LEAVES HOLES IN THE EXISTING WALLS, FLOORING, FLOOR SLAB, CEILINGS, AND/OR ROOF DECK, CONTRACTOR SHALL PATCH ALL HOLES LEFT FROM REMOVAL OF THESE ITEMS TO MATCH ADJACENT ASSEMBLY AND SURFACE PRIOR TO REFINISHING.
6. WHERE EXISTING OPENINGS IN MASONRY WALLS ARE TO BE FILLED WITH SIMILAR MASONRY UNITS, TOOTH-IN SOLID BRICK OR CMU AT JAMBS.
7. REFER TO THE UNDERSLAB MEP PIPING PLANS FOR ADDITIONAL AREAS OF PATCHING CONCRETE FLOORS FOR UNDERSLAB PIPING NOT SHOWN ON THE ARCHITECTURAL PLANS.

ARCHITECT OF RECORD
Neumann Monson Architects
221 East College Street | Suite 303
Iowa City, Iowa 52240
319.336.7818

418 6th Avenue | Suite 209
Des Moines, Iowa 50309
319.336.7500

CONSULTANTS
Maintenance Design Group
Design
1600 Stout St., Ste. 940
Denver, CO 80202
303.950.0206

Ruber Rhodes Engineering
Structural Engineer
112 E. Washington St.
Iowa City, IA 52240
319.333.7900

Modus Engineering
Mechanical/Electrical Engineer
118 E. College St.
Iowa City, IA 52240
319.246.7500

Snyder & Associates
Civil Engineer
320 E. Pireneis St.
Iowa City, IA 52240
319-359-7676

C-Wise
LEED Consultant
906 S. 7th Ave.
Iowa City, IA 52240
319-621-4166

Genus Landscape Architects
Landscape Architects
325 East 5th Street
Des Moines, IA 50309
515-264-1919

PROJECT NAME
IOWA CITY PUBLIC WORKS PHASE 1

OWNER
City of Iowa City
410 E. Washington St.
Iowa City, Iowa 52240
319.386.0000

PROJECT NO. 17.009

ISSUE

DATE	DESCRIPTION
03/11/2018	DESIGN DEVELOPMENT

© NEUMANN MONSON INC.
Unauthorized copying, disclosure or construction without written permission by Neumann Monson Inc. is prohibited.

PRELIMINARY
NOT FOR CONSTRUCTION

SHEET NAME
OVERALL PLANS

SHEET NUMBER

A-100

NEUMANN MONSON ARCHITECTS